

H-BEAM CLAMP

KLAMMER FÜR H-TRÄGER

- › Klammer für das vibro Rammen und Herausziehen von H-Trägern in verschiedenen Bodenarten

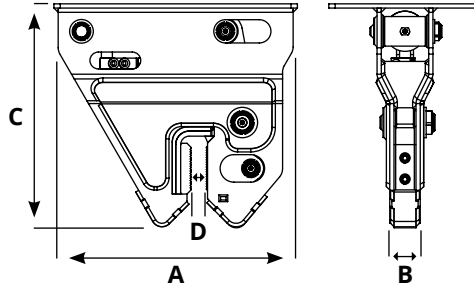

| Model | A mm | B mm | C mm | D mm | Press. Bar | Force max press | Kg. | Model. PLURY |
|-----------------------------|------|------|------|------|---------------------|---------------------------|-----|---|
| H-BEAM CLAMP 20 GRIP | 580 | 72 | 430 | 35 | 200 ----- 250 | 20 Ton ----- 23 Ton | 95 | W2 60.0 W2 80.0 W2 100.0 W2 120.0 W2 150.0 W2 180.0 |



| Model | Model. PLURY |
|-------------------------------------|--|
| 2-HOSES VALVE KIT 12Volt - 3 | W2 60.0 W2 80.0 W2 100.0 W2 120.0 W2 150.0 W2 180.0 |
| 2-HOSES VALVE KIT 24Volt - 3 | W2 60.0 W2 80.0 W2 100.0 W2 120.0 W2 150.0 W2 180.0 |



| Model | Model. PLURY |
|---------------------------------|--|
| 2-HOSES SHEET PILE CLAMP | W2 60.0 W2 80.0 W2 100.0 W2 120.0 W2 150.0 W2 180.0 |
| ELECTRICAL KIT | / |

